

MAIN PARTICULARS

Owner	IGOPL OFFSHORE Pvt. Ltd.
Upgraded	2008
Builder	HMS (UK)
Certification Standard	DO18
Audited to	IMCA D024
Last Audited	September 2008
Pressure Rated	21 bar (150 msw)



MAIN COMPONENTS

Main Module c/w Bell and LARS
Sat/Dive Control Unit
Hyperbaric Rescue Chamber (HRC) and Launch System
HRC Fly Away Package Control Unit
Main Umbilical Basket
Emergency Umbilical (For main umbilical)
Machinery Container
Hydraulic Power Pack

POWER SUPPLY REQUIREMENTS

Electric Power System	440v,60 Hz
Emergency Generators	250 kVA
Compressor Air	400 cfm,90 psi
Seawater	25 gpm @2-4 bar
Fresh Water	3 gpm @2-3 bar

DIVING COMPONENTS

Main Chamber : 6 Man; Twin Lock
HRC: 4 Man; Twin Lock
TUP
Bell : 2 Man

DIVE CONTROL UNIT

Diver Gas Reclaim System Control Panel c/w Gas Analyzers
Main Chamber Control Panel
TUP control Panel
HRC Control Panel
Chamber and heating Control Panel
Dive /Bell Control Panel
Un-Scrambler Communication & topside thru-water
CCTV To Chambers
Diver Video Surface and Black Box Unit

DIVING BELL

Capacity	2 Divers
Diver Lock-Out	2 Divers
Jewel 601 17B Reclaim Hats	2
KMB 18 Band Mask	2
Lighting	Internal & External
Emergency Communications	Through Water Communication & S/P Phone.
Mating to Main Chamber	Side-mating/Top-mating
Bell Bottom / Top Door	Hydraulic
On-board Gas	60.0m3 in 2 Banks
On-board O2	7.5 m3 in 1 Cylinder
CO2 Removal	1 x DH 21 Scrubber +Lexman
System Mating	Side-mating/Top-mating

HYPERBERIC RESCUE CHAMBER

On-board emergency gas and battery power fro 72 hrs
HRC c/w 12 x Full Seat Harness & approved safety Helmets
1 x Toilet, Shower, Wash Basin
4 x HCU, 13 x BIBS complete with dump, 6 x Carbon dioxide
Lifting Frame & Rigging , towing Bridge
Scrubbers, Medical Lock & Communications Transfer, 6 x Bunk Beds

LIFE SUPPORT MACHINERY

Driver Hot-Water Unit	HMS HWU 100% Redundancy
ECU Units	4 x Kinergetics 126k
Chamber Portable Water Unit (Hot/Cold)	
Divex Air Driven Reclaim Unit	

HRC EMERGENCY CONTROL UNIL

Control Panel With Window Aircon
Communications & Analyzers
Environment Control Heating & Cooling

LIFE SUPPORT MACHINERY

Driver Hot-Water Unit	HMS HWU 100% Redundancy
ECU Units	4 x Kinergetics 126k
Chamber Portable Water Unit (Hot/Cold)	
Divex Air Driven Reclaim Unit	

The Saturation Diving System is built and maintained in accordance with International Marine Contractors Association (IMCA) guidelines for offshore Diving Systems D018, to carry out Saturation diving operations up to 150 m water depth.

****The above specifications reflect to the current configuration of the system. Specifications are subjected to change without prior notice**

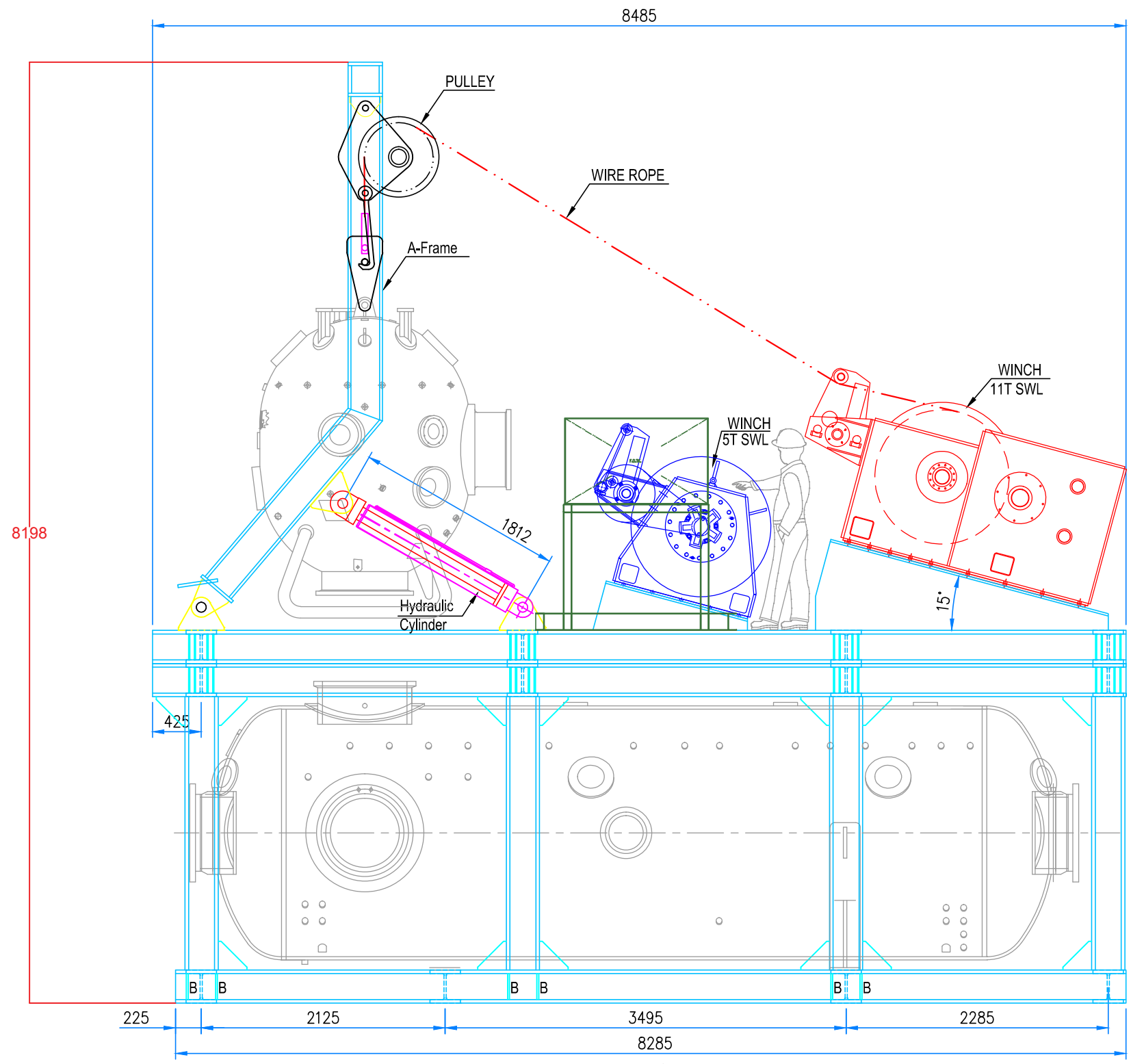

PROFILE
STACKING CONDITION (Top Mating/Side Mating)

IGOPL OFFSHORE PVT. LTD.

SATURATION DIVING SYSTEM (SIDE VIEW)

SHEET 1 OF 2

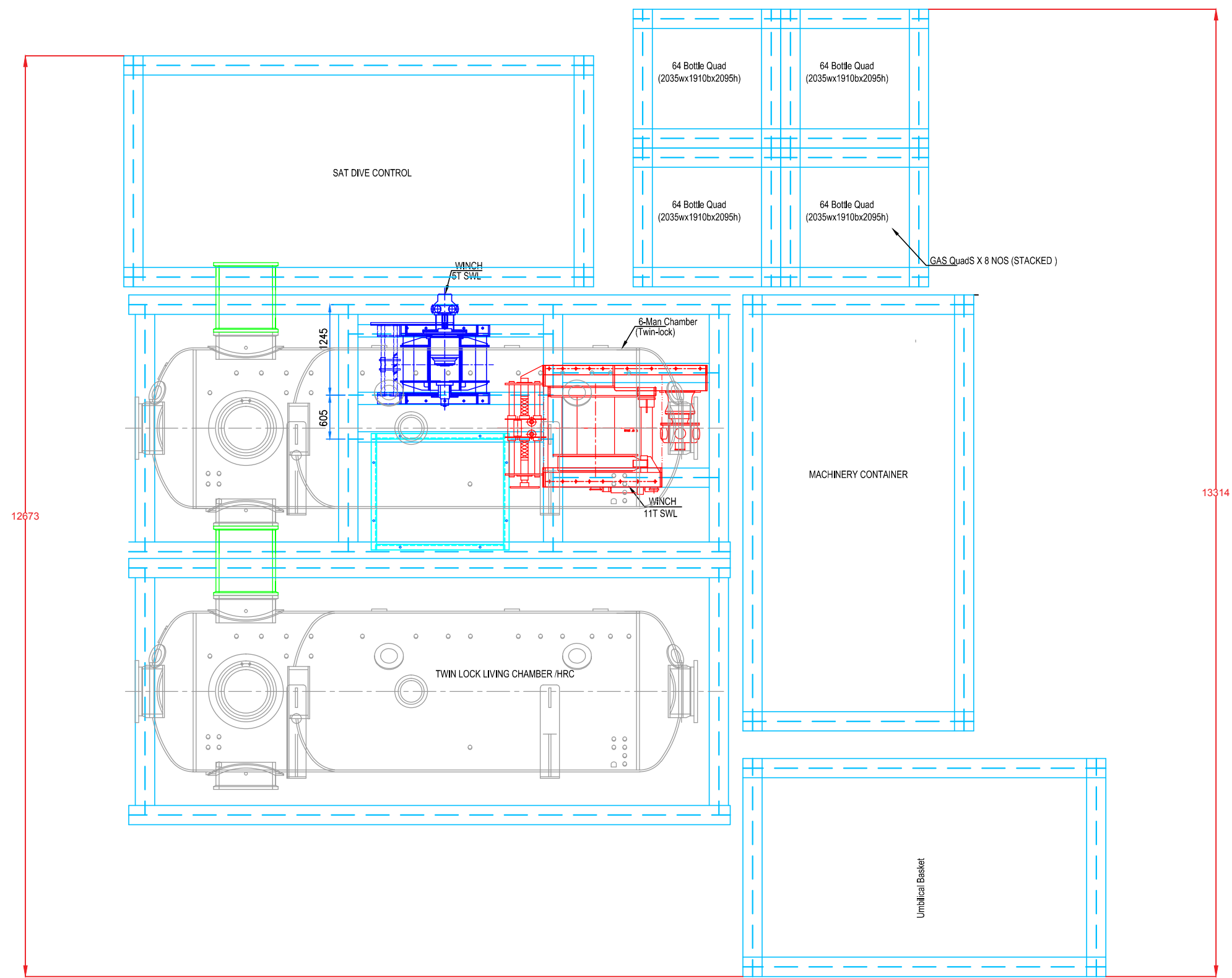

TOTAL DECK SPACE TAKEN = 12673 X 13314

SR. NO.	DESIGNATION	DIMENSION (W x B x H)	WEIGHT (KG)
1	A-FRAME SKID	8485 x 3665 x 5000	14000 KG
2	BELL+CLAMP WEIGHT	3.43 cu.m	9000 KG
3	MAIN CHAMBER	8285 x 3400 x 3380	40500 KG
4	DDC- CHAMBER	8385 x 3400 x 3380	35000 KG
5	SAT DIVE CONTROL	8485 x 3665 x 5000	10000 KG
6	MACHINERY CONTAINER	6096 x 2514 x 3380	10000 KG
7	UMBILICAL BASKET+UMBILICAL	5580 x 3500 x 3500	1800KG
8	STANDARD 64 BOTTLE QUAD	5580 x 3500 x 3500	7500KG